

Mount Pleasant Road, Hastings TN34 3SN

Offers in excess of £275,000



A beautifully presented two bedroom TERRACED VICTORIAN HOUSE located on the CUSP OF THE WEST HILL, enviably positioned within immediate walking distance of local shops, Ore railway station, the West Hill and Hastings Old Town. Hastings Town Centre, the beach and Alexandra Park are also within easy reach. The accommodation here is arranged as an OPEN PLAN LIVING AND DINING ROOM which enjoys a BAY FRONTED ASPECT and measures an impressive 24'8 x 11'6 providing plenty of room for a full dining table to create the ideal sociable setting. The MODERN FITTED KITCHEN is separate offering INTEGRATED APPLIANCES and ample storage space along with access to the rear garden. The first floor houses TWO WELL PROPORTIONED DOUBLE BEDROOMS together with a STYLISH FAMILY BATHROOM where there is a bath with shower and screen over. The SOUTH FACING rear garden has been LANDSCAPED featuring Indian Sandstone paving of which is bordered by slatted fencing to create the ideal space to entertain or DINE AL-FRESCO. Being sold with NO ONWARD CHAIN, this stylish property would make the PERFECT FAMILY HOME and

GROUND FLOOR
454 sq.ft. (42.1 sq.m.) approx.

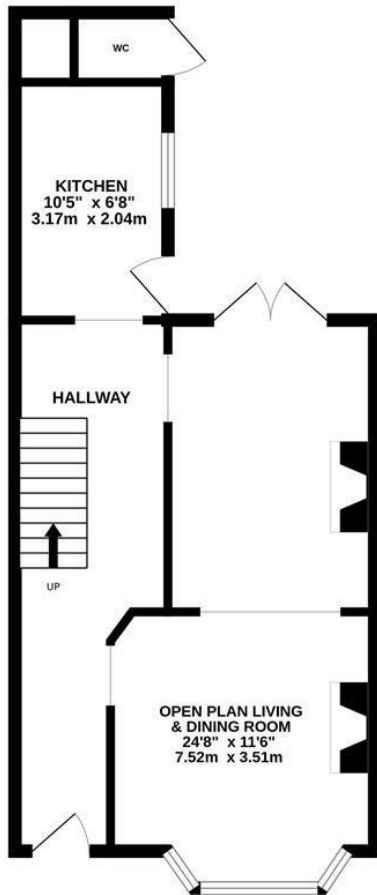

1ST FLOOR
403 sq.ft. (37.5 sq.m.) approx.

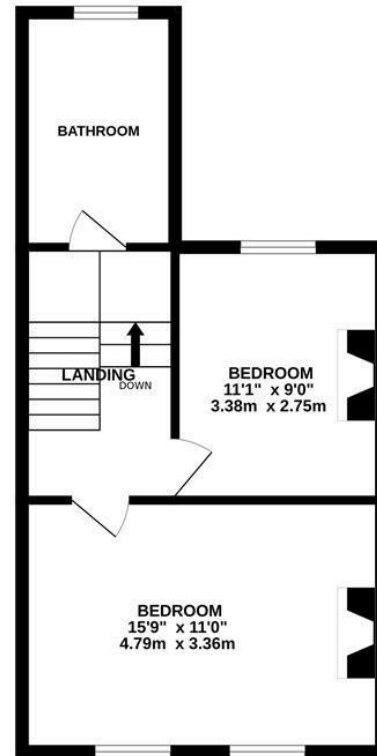

TOTAL FLOOR AREA : 857 sq.ft. (79.6 sq.m.) approx.

Whilst every attempt has been made to ensure the accuracy of the floorplan contained here, measurements of doors, windows, rooms and any other items are approximate and no responsibility is taken for any error, omission or mis-statement. This plan is for illustrative purposes only and should be used as such by any prospective purchaser. The services, systems and appliances shown have not been tested and no guarantee as to their operability or efficiency can be given.
Made with Metropix ©2025

